

# Perlite

The Superior  
Lightweight Aggregate  
for Portland Cement Plasters  
and Gypsum Plasters

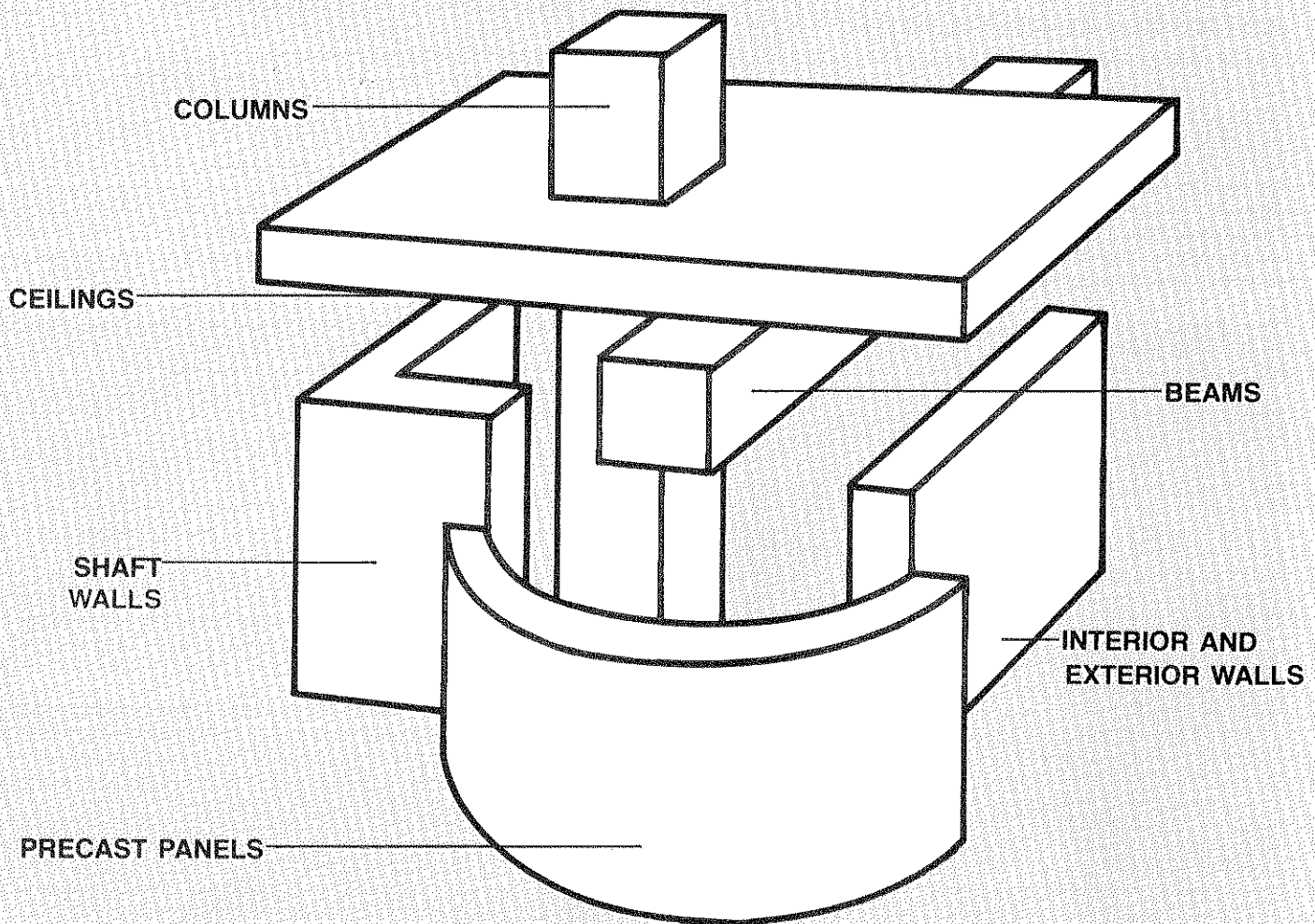

#### Contents

Advantages and Other Considerations	2
Guide Specifications	
Perlite Gypsum Plasters	3
Perlite Portland Cement Fiber Reinforced Plasters	4
Fire Ratings	
Structural Steel Columns	6
Walls and Partitions	7
Floors, Roofs and Ceilings	10

#### ■ PERLITE AGGREGATE

Perlite is a siliceous volcanic rock containing a small amount of combined water. When crude perlite ore particles are heated to plasticity, they expand to form countless sealed glassy cells. This accounts for the excellent insulating properties and light weight of expanded perlite.

#### ■ PORTLAND CEMENT PLASTER

Perlite portland cement based plaster can be used on new or remodel work - as a base coat for stucco finishes, ceramic tile or masonry veneer. Perlite portland cement plasters are approved for as much as 4-hour fire protection of structural steel columns. They are ideal for weather exposed structural steel elements requiring fire protection. Flexural strength and resistance to hydration cracking of portland cement plaster is dramatically enhanced by the addition of alkali-resistant glass or polypropylene fiber shorts. Their use is strongly recommended when designing perlite portland cement mixes. All plasters

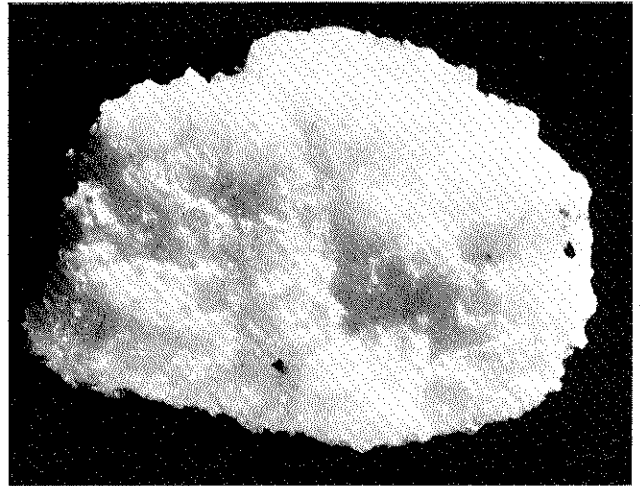

*Photograph of greatly enlarged particle of expanded perlite as used in perlite gypsum plaster and perlite portland cement plaster.*

containing portland cement must be applied over metal or wire lath or other suitable surfaces prepared with an approved liquid bonding agent. Plastering on metal or wire lath is typically three coat work.

#### ■ GYPSUM PLASTER

Perlite plaster aggregate mixed with gypsum provides an ideal base coat plaster for interior walls and ceilings and for membrane fireproofing to the underside of floor and roof assemblies, or structural steel members.

#### Advantages of Perlite Plaster

**Lightweight** - Weighs approximately 60% less than ordinary sand plaster, saving about one ton (900 kg) for every 100 yd<sup>2</sup> (84 m<sup>2</sup>) of material applied ½ in (13 mm) thick. This substantial weight savings makes perlite portland cement plaster particularly suitable for panelized curtain wall construction.

**Insulating** - Four times more resistant to heat transmission than sand plaster . . . permits savings in heating and air conditioning costs . . . conserves energy.

**Fire Retardant** - Non-combustible and non-toxic . . . provides up to 5-hour fire protection with minimum weight and thickness . . . more than 50 fire tested designs by recognized laboratories.

**Adaptable** - Packaged in 3 or 4 ft<sup>3</sup> bags in the United States and Canada and in 100 litre sacks in most other countries . . . which are easy to stock on difficult building sites unlike piles of sand, easy to measure, mix and handle . . . job mixing permits proper proportioning to meet different plaster based materials specifications.

**Durable** - Cannot rot or decay . . . strong but not brittle . . . endures freeze-thaw exposure . . . successfully used on major construction projects since 1946.

#### Other Considerations

Normal limitations for gypsum plaster and portland cement plaster apply.

Alkali-resistant glass fibers or polypropylene fibers must be added to perlite portland cement mixes to enhance flexural properties.

Because of its insulating value, perlite gypsum plaster is not recommended over radiant heating panels.

Large expanses of plaster should be divided with properly installed relief joints to minimize stress build-up from structural movement and other sources. Reinforcing lath must be discontinued at relief joints.

Over monolithic concrete, the thickness of bonding plaster and perlite gypsum basecoat shall not exceed ¾ in (10 mm) on ceilings and 5/8 in (16 mm) on walls. If additional thickness is required to produce desired lines or surfaces, self-furred metal lath shall be secured to concrete surfaces.

Gypsum plaster, when used with perlite, should be milled and set "for use with lightweight aggregates."

Where perlite gypsum plaster with smooth troweled finish is to be applied over expanded metal or wire lath, it is recommended that perlite fines be added to the finish coat mix.

**Note:** All numerical values include approximate SI (International System of Units) equivalents. Packaging of materials varies in different countries and the user should check with local suppliers for proper proportioning of mix ingredients.

#### ■ PERLITE GYP SUM PLASTER

#### PART I - GENERAL

##### 1.01 SCOPE

The plastering contractor shall furnish all labor, materials, equipment and supervision for installing the perlite gypsum base coat plaster and finish coat in accordance with the recommendations as published by Perlite Institute, Inc., applicable drawings, and contract documents. Application of perlite gypsum base coat plaster and finish coats shall be in accordance with ASTM C842.

##### 1.02 WORK BY OTHERS

Furring and lathing, sprayed fiber and cementitious mixtures, spray applied decorative finishes, gypsum wallboard or additional material shall be provided by others.

#### PART 2 - PRODUCTS

##### 2.01 IDENTIFICATION AND MARKINGS.

Identify packaged materials with manufacturers' brand name. Provide similar information in the shipping advices accompanying the shipment of bulk materials.

##### 2.02 DELIVERY AND STORAGE OF MATERIALS.

Deliver materials to job site in original undamaged containers and store materials off the ground protected from moisture and dampness.

##### 2.03 MATERIALS.

Materials shall conform to requirements of the referenced specifications and standards and to the requirements specified herein:

- (a) Gypsum Neat Plaster - ASTM C28
- (b) Perlite Aggregate - ASTM C35
- (c) Water: Clean and potable

TABLE 1. RECOMMENDED MAXIMUM PROPORTIONS OF PERLITE PER 100 lb (45 kg) OF GYP SUM PLASTER

	TWO COAT WORK	THREE COAT WORK	
	DOUBLE-UP PLASTERING	SCRATCH COAT	BROWN COAT
GYP SUM LATH	2 ft <sup>3</sup> (60 litres)	2 ft <sup>3</sup> (60 litres)	** 2 ft <sup>3</sup> (60 litres)
MASONRY		2 ft <sup>3</sup> (60 litres)	** 2 ft <sup>3</sup> (60 litres)
METAL LATH	3 ft <sup>3</sup> (85 litres)	3 ft <sup>3</sup> (85 litres)	3 ft <sup>3</sup> (85 litres)

\*Except monolithic concrete.

\*\*Where plaster is 1 inch (26 mm) or more in total thickness the proportions for the second coat may be increased to 3 ft<sup>3</sup> (85 litres).

#### PART 3 - EXECUTION

##### PROPORTIONS AND APPLICATION

General: All metal lath surfaces and gypsum lath ceilings attached by resilient clips shall be three-coat work. Unit masonry and gypsum lath may be either three-coat or two-coat work.

##### Three Coat Work.

- 1) **Scratch Coat:** First coat shall be not more than 2 ft<sup>3</sup> (60 litres) of perlite to 100 lb (45 kg) of neat gypsum. On masonry surfaces, except monolithic concrete, the mix shall be not more than 3 ft<sup>3</sup> (85 litres) of perlite to 100 lb (45 kg) of neat gypsum.
- 2) **Brown Coat:** The second coat shall be not more than 3 ft<sup>3</sup> (85 litres) of perlite to 100 lb (45 kg) of neat gypsum.

##### Two Coat Work.

- 1) **Gypsum Lath:** The mix for double-up work shall be not more than 2 ft<sup>3</sup> (60 litres) of perlite to 100 lb (45 kg) of neat gypsum.
- 2) **Unit Masonry:** The mix shall be not more than 3 ft<sup>3</sup> (85 litres) of perlite to 100 lb (45 kg) of neat gypsum.
- 3) **Monolithic Concrete:** A leveling coat mix of not more than 3 ft<sup>3</sup> (85 litres) of perlite to 100 lb (45 kg) of neat gypsum shall be applied over an approved liquid bonding agent.
- 4) **Proportioning of Finishing Coat:** When a smooth trowelled lime putty gypsum finish is used, it shall contain perlite fines in the proportions of 0.5 to 1.0 ft<sup>3</sup> (15 to 30 litres) per 100 lb (45 kg) of gauging plaster.



Lightweight perlite gypsum plaster provides an ideal base coat plaster for interior walls and ceilings.

#### ■ PERLITE PORTLAND CEMENT FIBER-REINFORCED PLASTER

##### PART I - GENERAL

###### 1.01 SCOPE

The plastering contractor shall furnish all labor, materials, equipment and supervision for installing the perlite portland cement based plaster in accordance with the recommendations as published by Perlite Institute, Inc., applicable drawings, and contract documents.

###### 1.02 WORK BY OTHERS

Furring and lathing, sprayed fiber mixtures, decorative finishes, wall reinforcement, gypsum plaster, gypsum wallboard or additional material shall be provided by others.

##### PART 2 - PRODUCTS

###### 2.01 IDENTIFICATION AND MARKINGS.

Identify packaged materials with manufacturers' brand name. Provide similar information in the shipping advices accompanying the shipment of bulk materials.

###### 2.02 DELIVERY AND STORAGE OF MATERIALS.

Deliver materials to job site in original undamaged containers and store materials off the ground protected from moisture and dampness.

###### 2.03 MATERIALS.

Materials shall conform to requirements of the referenced specifications and standards and to the requirements specified herein:

- (a) Portland Cement - ASTM C150
- (b) Hydrated Lime - ASTM C206
- (c) Perlite Aggregate - ASTM C35
- (d) Sand Aggregate - ASTM C897
- (e) Water: Clean and Potable



*The walls on this luxury high rise condominium consist of flat and curved steel stud framed elements that were shop assembled and plastered with perlite portland cement fiber-reinforced plaster.*

- (f) Fibers: Alkali-resistant glass fibers or polypropylene fiber shorts. For hand applications 1 in (25 mm) long fibers should be used but ¼ to ½ in (6 to 13 mm) long fibers are preferable for machine application.

**TABLE 2. MIX PROPORTIONS FOR PERLITE PORTLAND CEMENT FIBER-REINFORCED PLASTERS**

PERLITE PORTLAND CEMENT PLASTER							
COAT	VOLUME CEMENT	MAX. VOL. PERLITE PER VOL. CEMENT	FIBERS	APPROX. MIN. THICKNESS	MIN. PERIOD MOIST CURING	MIN. INTERVAL BETWEEN COATS	
FIRST	1	4	Yes*	¾ in (10 mm)	48 Hours	48 Hours	
SECOND	1	4	Yes*	1st and 2nd coats Total ¾ in (19 mm)	48 Hours	7 Days	
FINISH	1	3	—	1st, 2nd and finish coats ¾ in (22 mm)			
PERLITE PORTLAND CEMENT PLASTER WITH LIME							
COAT	VOLUME CEMENT	MAX. VOL. LIME PER VOL. CEMENT	MAX. VOL. PERLITE PER COMBINED VOL. CEMENT and LIME	FIBERS	APPROX. MIN. THICKNESS	MIN. PERIOD MOIST CURING	MIN. INTERVAL BETWEEN COATS
FIRST	1	1	4	Yes*	¾ in (10 mm)	48 Hours	48 Hours
SECOND	1	1	4½	Yes*	1st and 2nd coats Total ¾ in (19 mm)	48 Hours	7 Days
FINISH	1	1	3	—	1st, 2nd and finish coats ¾ in (22 mm)		

\*Fibers should be incorporated at a rate of approximately 4 lb (2 kg) of alkali-resistant glass fibers or 2 lb (1 kg) of polypropylene fibers per cubic foot (30 liter) of cement.

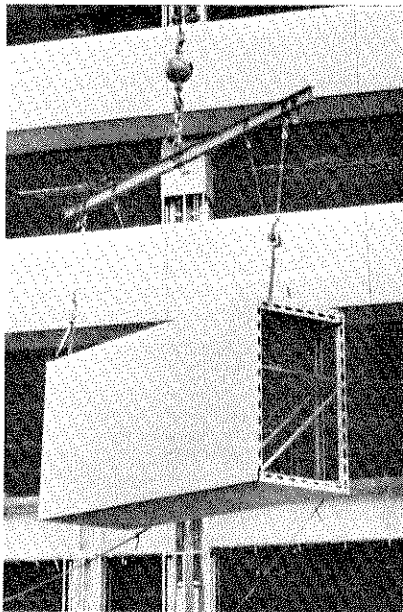

*Perlite portland cement fiber-reinforced panels using steel studs may be shop fabricated and shipped to the job site for installation.*

metal or wire fabric lath and shall be not less than two coats when applied over masonry or concrete backing.

(a) The first coat shall be applied with sufficient material and pressure to fill solidly all openings in the lath. The surface shall be scored horizontally to provide adequate mechanical bond to the brown coat. Keep this scratch coat damp for a minimum of 48 hours, including weekends and holidays. As an alternate method of application on three coat work, the brown coat may be applied immediately after the scratch coat has attained sufficient rigidity to support it.

(b) The brown coat shall be brought out to proper thickness, rodged level and properly floated to density. Leave sufficiently rough to receive the finish coat. Keep brown coat damp for at least 48 hours, including weekends and holidays. Allow the brown coat to dry at least 5 days before applying the finish coat.

**Note:** In panelized constructions, where panels are fabricated in a horizontal position, the plaster may be placed monolithically, i.e., poured in one coat and screeded level. When plaster begins to set but is still sufficiently plastic that it can be manipulated with the tools, it shall be properly floated to provide compaction.

#### 2.04 PLASTER PHYSICAL PROPERTIES

The perlite portland cement plaster shall have an oven dry density of 46 to 48 lb/ft<sup>3</sup> (740 to 770 kg/m<sup>3</sup>) and a minimum compressive strength of 1000 psi (7000 kPa) at 28 days.

#### PART 3 - EXECUTION

##### GENERAL

Relief joints which will accommodate expansion and contraction of the lath and plaster shall be properly installed not over 10 ft (3 m) apart in the field of the plaster and at all junctures of plaster with dissimilar materials. Intersecting planes of plaster, such as walls and ceilings, shall be unrestrained with the lath cut and casing beads installed in all edges.

##### 3.01 PROPORTIONS

See Table 1 for typical proportions for various perlite cement mixes. Plaster practices vary in different geographical areas and this should be considered. Sand may be mixed with perlite aggregate in the maximum ratio of 1:1 to increase physical properties, except in certain fire rated constructions. No matter which mix design is selected, the use of fibers is strongly recommended in base coats. Approximately 4 lb (2 kg) of alkali-resistant glass fibers or 2 lb (1 kg) of polypropylene fibers should be added per sack (1 ft<sup>3</sup> or 30 litres) of cement.

##### 3.02 MIXING

Mix perlite portland cement fiber-reinforced plaster in a paddle type mixer. Place 80% of the required water in the mixer, followed by the lime (if used) and cement. Add the balance of the water and mix until the slurry is uniform, approximately 1 to 1½ minutes. Add the aggregate and the chopped fibers while the mixer is turning. Fibers must be sprinkled and not dumped in. Mix until thoroughly blended but not longer than 4 minutes. Do not overmix!

##### 3.03 APPLICATION

Plastering with perlite portland cement fiber-reinforced plaster shall be not less than three coats when applied over expanded



*Medical building featuring exterior walls of shop manufactured perlite portland cement fiber-reinforced plaster panels.*

1. Scratch coat: 2 ft<sup>3</sup> (60 litres) Perlite aggregate to 100 lb (45 kg) gypsum.  
Brown coat: 3 ft<sup>3</sup> (85 litres) Perlite aggregate to 100 lb (45 kg) gypsum.
2. Scratch and brown coats: 2½ ft<sup>3</sup> (70 litres) Perlite aggregate to 100 lb (45 kg) gypsum.
3. Scratch and brown coats: 3 ft<sup>3</sup> (85 litres) Perlite aggregate to 100 lb (45 kg) gypsum.
4. Scratch and brown coats: 4 ft<sup>3</sup> (110 litres) Perlite aggregate to 100 lb (45 kg) gypsum.

5. Scratch and brown coats: 2 ft<sup>3</sup> (60 litres) Perlite aggregate to 100 lb (45 kg) gypsum.  
All tests conducted in accordance with American Standard Time-Temperature Test Procedure (ASTM E-119)  
U.L. - Underwriters Laboratories  
N.B.S. - National Bureau of Standards  
I.C.B.O. - International Conference of Building Officials  
O.S.U. - Ohio State University

**4 HOURS**  
U.L. DESIGN  
No. X402

1-3/4 in. (45 mm) of perlite-gypsum plaster<sup>1</sup> on face of self-furring metal lath wrapped around column with expanded metal corner beads adjusted for the required plaster thickness.

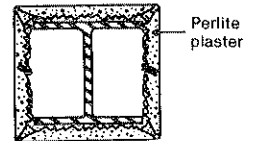

**4 HOURS**  
U.L. DESIGN  
No. X406

1-1/2 in. (38 mm) of perlite-gypsum plaster<sup>1</sup> on face of diamond mesh metal lath spaced from flanges by 3/4 in. (19 mm) cold-rolled furring channels at approx. 24 in. (610 mm) vertical spacings. Expanded metal corner beads. No back fill plaster required between metal lath and column flanges.

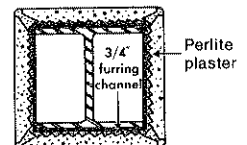

**4 HOURS**  
N.B.S.  
BMS-135

Two 3/4 in. (19 mm) coats of perlite-gypsum plaster<sup>1</sup> over two layers of 1/2 in. (13 mm) long-length gypsum lath held by tie wires and wrapped with 1 in. (26 mm) wire mesh. Expanded metal corner beads. Total thickness of plaster: 1-1/2 in. (38 mm).

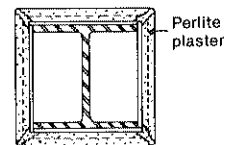

**4 HOURS**  
U.L. DESIGN  
No. X407

2-1/8 in. (54 mm) perlite-portland cement plaster\*\* machine applied to paperbacked wire fabric wrapped around column and reinforced with 2 in. (51 mm) wire mesh applied over scratch coat.  
\*\*(Scratch and brown coat: 3-1/2 cu. ft. (100 litres) perlite plaster aggregate to 1 bag portland cement).

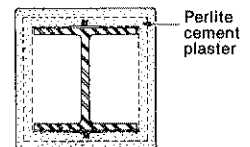

**3 HOURS**  
N.B.S.

1 3/8 in (35 mm) of perlite-gypsum plaster<sup>1</sup> on 3/8 in (10 mm) gypsum lath boxed around column and fastened with wire ties.

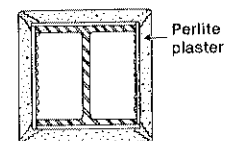

**3 HOURS**  
U.L. DESIGN  
No. X402

1-3/8 in. (35 mm) of perlite-gypsum plaster<sup>1</sup> on face of self-furring metal lath wrapped around column with expanded metal corner beads adjusted for the required plaster thickness.

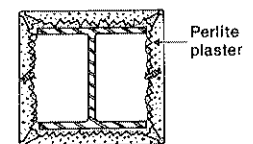

**3 HOURS**  
N.B.S.  
BMS-135

Two 3/4 in. (19 mm) coats of perlite-gypsum plaster, with 1 in. (26 mm) mesh fabric between coats; applied over one layer of 1/2 in. (13 mm) long-length gypsum lath held by tie wires. Expanded metal corner beads. Total thickness of plaster 1-1/2 in. (38 mm).

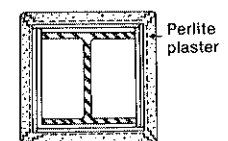

**3 HOURS**  
N.B.S.  
BMS-135

1 in. (26 mm) of perlite-gypsum plaster<sup>2</sup> over two layers 1/2 in. (13 mm) long-length gypsum lath held by tie wires and wrapped with 1 in. (26 mm) hexagonal wire mesh. Expanded metal corner beads.

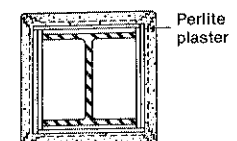

**2 HOURS**  
U.L. DESIGN  
No. X-402

1 in. (26 mm) of perlite-gypsum plaster<sup>1</sup> on face of self-furring metal lath wrapped around column with expanded metal corner beads adjusted for the required plaster thickness.

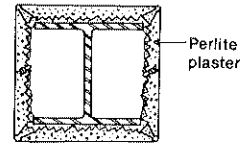

**2 HOURS**  
U.L. DESIGN  
No. X-401

1 in. (26 mm) of perlite-gypsum plaster<sup>1</sup> on face of metal lath furred 1-1/4 in. (32 mm) from flanges by metal lath spacers. No plaster fill behind metal lath. Expanded metal corner beads.

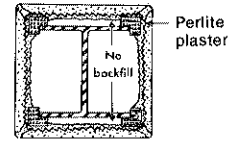

**2 HOURS**  
N.B.S.  
BMS-135

1 in. (26 mm) of perlite-gypsum plaster<sup>2</sup> on 3/8 in. (10 mm) thick gypsum lath held by double strands of 18 ga. tie wires spaced 2 in. (51 mm) from ends of lath and spaced 15 in. (381 mm) at intermediate points. Expanded metal corner beads.

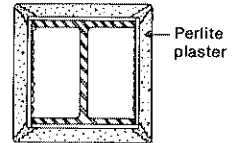

# Perlite

## FIRE RATINGS

### Walls and Partitions

**4 HOURS**  
O.S.U.  
No. 5645

Non load-bearing exterior wall consisting of 7/8 in. (22 mm) perlite / cement / lime plaster over wire lath on exterior surface. Interior surface of 5/8 in. (16 mm) Type "X" gypsum wallboard screw attached to 3 5/8 in. (92 mm) Cee studs; 3 1/4 in. (83 mm) perlite / cement / lime backplaster spray applied in the stud cavity. Fire side-exterior surface. Achieved 2 hours when tested from gypsum wallboard side.

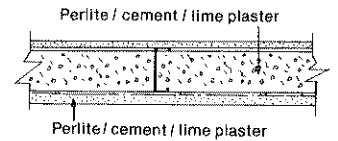

**4 HOURS**  
U.L. DESIGN  
No. U-201

Nonbearing wall 6 in. (152 mm) thick (not including weatherproof facade) consisting of 4 in. (102 mm) spray-applied perlite concrete on paper-backed wire fabric on one face; 1 in. (26 mm) perlite-gypsum plaster on paper and aluminum foilbacked wire fabric on other face, with furring channels forming 1 in. (26 mm) air space between the two sections.

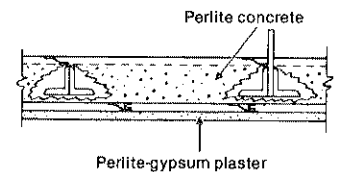

**2 HOURS**  
U.L. DESIGN  
No. U-203

Non load-bearing wall consisting of 3 in. (76 mm) thickness perlite concrete spray-applied to paper-backed wire lath attached to 4 in. (102 mm) steel studs 16 in. (406 mm) on center.

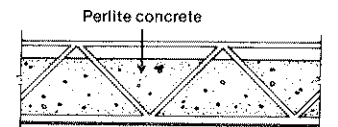

**2 HOURS**  
U.L. DESIGN  
No. U-413

2-1/2 in. (64 mm) thick non load-bearing solid partition of perlite-gypsum plaster<sup>1</sup> on a base of expanded metal lath supported by 3/4 in. (19 mm) cold-rolled steel channels set into floor base clips and ceiling runners.

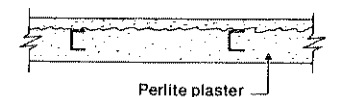

**2 HOURS**  
University  
of California  
Jan. 1948

Non load-bearing hollow partition of 4 in. (102 mm) metal studs protected on both sides with 1 in. (26 mm) perlite-gypsum plaster<sup>1</sup> on face of metal lath.

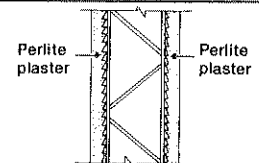

**2 HOURS**  
ICBO  
Research Report  
No. 2531

2-1/2 in. (64 mm) solid plaster nonbearing partition of 2-1/8 in. (54 mm) perlite-gypsum plaster applied on 3/8 in. (10 mm) type X gypsum lath; welded or woven wire lath is attached to the face side of the 3/4 in. (19 mm) metal channel studs.

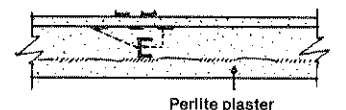

# Perlite

## FIRE RATINGS

### Walls and Partitions (continued)

**2 HOURS**  
ICBO  
Research Report  
No. 2531

Solid plaster nonbearing partition of 2-1/2 in. (64 mm) perlite-gypsum plaster applied on self-furred metal lath attached to 3/4 in. (19 mm) metal channel studs, 12 in. (305 mm) on center.

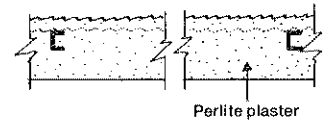

**2 HOURS**  
ICBO  
Research Report  
No. 2531

Solid plaster nonbearing partition of 2-1/2 in. (64 mm) perlite-gypsum plaster applied to self-furred paperback, welded or woven wire fabric wire tied to 3/4 in. (19 mm) metal channel studs, 12 in. (305 mm) on center.

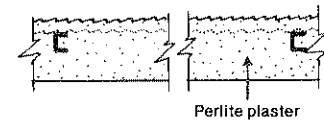

**2 HOURS**  
ICBO  
Research Report  
No. 2531

Solid plaster nonbearing partition of 2-1/2 in. (64 mm) perlite-gypsum plaster applied to welded or woven wire fabric wire tied to 3/4 in. (19 mm) metal channel studs with min. 5/8 in. (16 mm) thick gypsum strips attached to back side of studs.

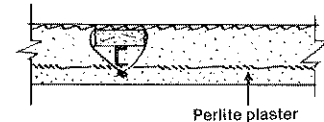

**2 HOURS**  
ICBO  
Research Report  
No. 2531

Solid plaster nonbearing partition of 2-1/2 in. (64 mm) perlite-gypsum plaster applied to metal lath or welded or woven wire fabric wire tied or nailed to 3/4 in. (19 mm) nailable channel studs with min. 5/8 in. (16 mm) thick gypsum strips attached to back side of studs.

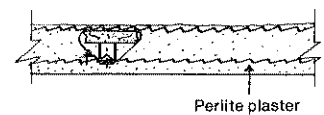

**2 HOURS**  
ICBO  
Research Report  
No. 2531

Nonbearing partition 4-1/4 in. (108 mm) thick of 3/4 in. (19 mm) perlite-gypsum plaster applied over min. 3/8 in. (10 mm) type X gypsum lath attached to back side of 2-1/2 in. (64 mm) metal studs with resilient metal clips; 3/4 in. (19 mm) perlite-gypsum plaster applied over 3/8 in. (10 mm) type X gypsum lath attached perpendicular to front side of studs with standard metal clips.

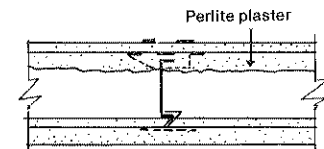

**2 HOURS**  
ICBO  
Research Report  
No. 2531

4-1/4 in. (108 mm) thick hollow nonbearing partition of 1 in. (26 mm) perlite-gypsum plaster applied over metal reinforcement installed on the back side of the assembly over 5/8 in. (16 mm) thick gypsum strips and wire tied to 2-1/2 in. (64 mm) metal studs; 1 in. (26 mm) perlite-gypsum plaster applied over paper-backed, welded or woven wire lath or metal lath wire tied to the front side of the assembly.

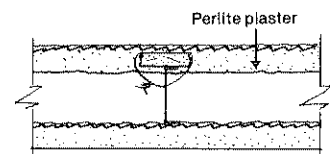

**2 HOURS**  
ICBO  
Research Report  
No. 2531

Solid plaster nonbearing partition of 2-1/2 in. (64 mm) perlite-portland cement plaster applied over self-furred paper-backed welded or woven wire lath, attached to the back side of 1-1/2 in. (38 mm) metal channel studs; welded or woven wire fabric lath without backing is attached to the face of the channel studs.

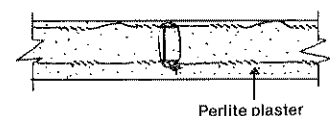

**1 1/2 HOURS**  
N.B.S.  
282 and 283

2 in. (51 mm) solid partition of perlite-gypsum plaster applied on 1/2 in. (13 mm) long-length gypsum lath 3/4 in. (19 mm) of plaster on both sides of lath.

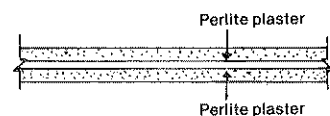

**1 1/2 HOURS**  
N.B.S. 252

Non load-bearing partition of 2 in x 4 in (51 mm x 102 mm) wood studs, 16 in (406 mm) on center, protected on both sides with 3/8 in (10 mm) gypsum lath covered with 1/2 in (13 mm) of perlite-gypsum plaster.<sup>2</sup>

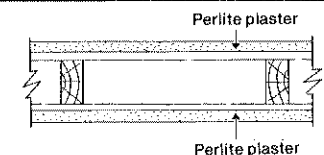



# Perlite

## FIRE RATINGS

### Walls and Partitions (continued)

**1 1/4 HOURS**  
N.B.S. 251

Load-bearing partition. Construction the same as above Test No. 252.

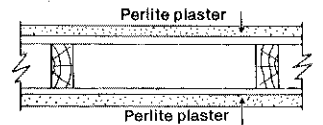

**1 HOUR**  
O.S.U.  
T-147

1-1/2 in. (38 mm) solid partition of perlite-gypsum plaster<sup>2</sup> applied over expanded metal lath on 3/4 in. (19 mm) steel channels.

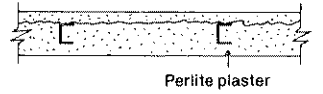

**1 HOUR**  
O.S.U.  
T-118

Hollow partition of 2 in x 4 in (51 mm x 102 mm) wood studs, 16 in (406 mm) on center, protected on both sides by 1/2 in (13 mm) of perlite-gypsum plaster<sup>2</sup> over gypsum lath supported by special resilient clips.

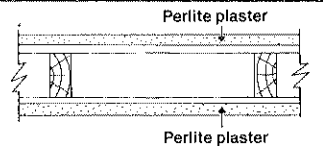

**1 HOUR**  
U.L. DESIGN  
No. U316

Hollow load-bearing partition of 2 in x 4 in (51 mm x 102 mm) wood studs, 16 in (406 mm) on center, protected on both sides with 1/2 in (13 mm) thick perlite-gypsum plaster<sup>2</sup> over 3/8 in (10 mm) thick perlite-gypsum plaster<sup>2</sup> over 3/8 in (10 mm) gypsum lath.

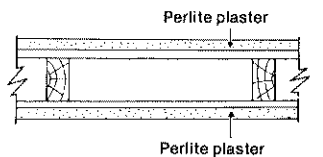

**1 HOUR**  
ICBO  
Research Report  
No. 2531

2 in. (51 mm) solid plaster nonbearing partition of 1-5/8 in. (41 mm) perlite-gypsum plaster applied on 3/8 in. (10 mm) type X gypsum lath.

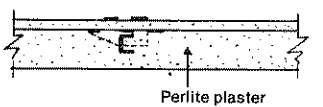

**1 HOUR**  
ICBO  
Research Report  
No. 2531

Solid plaster nonbearing partition of 2 in. (51 mm) perlite-gypsum plaster applied to self-furred paperbacked, welded or woven wire fabric lath attached to 3/4 in. (19 mm) metal channel studs, 16 in. (406 mm) on center.

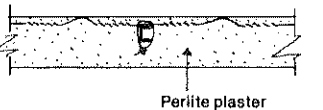

**1 HOUR**  
ICBO  
Research Report  
No. 2531

Solid plaster nonbearing partition of 2 in. (51 mm) perlite-gypsum plaster applied to welded or woven wire fabric lath wire tied to front side of 3/4 in. (19 mm) metal channel studs with 1/2 in. (13 mm) thick gypsum strips attached to back side of studs.

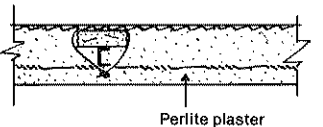

**1 HOUR**  
ICBO  
Research Report  
No. 2531

Solid plaster nonbearing partition of 2 in. (51 mm) perlite-gypsum plaster applied to metal lath or welded or woven wire fabric wire tied or nailed to 3/4 in. (19 mm) metal nailable channel studs with min. 1/2 in. (13 mm) thick gypsum strips attached to back side of studs.

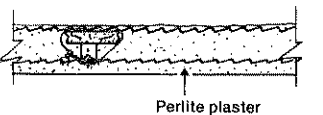

**1 HOUR**  
ICBO  
Research Report  
No. 2531

4 in. (102 mm) hollow nonbearing partition of 3/4 in. (19 mm) perlite-gypsum plaster applied over metal reinforcement attached to the back side of the assembly over 1/2 in. (13 mm) gypsum strips and wire tied to 2-1/2 in. (64 mm) metal studs. 3/4 in. (19 mm) perlite-gypsum plaster applied over paperbacked, welded or woven wire lath or metal lath wire tied to the front side of the assembly.

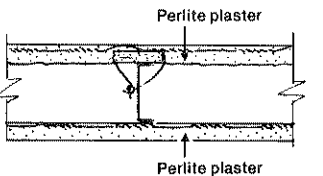

**1 HOUR**  
ICBO  
Research Report  
No. 2531

Solid plaster nonbearing partition of 2 in. (51 mm) perlite-Portland cement plaster applied over self-furred paperbacked welded or woven wire fabric lath wire tied to back side of 3/4 in. (19 mm) metal channel studs.

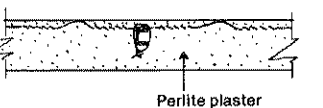

**1/2 HOUR**  
U.L. DESIGN  
No. U316

Interior finish on one face of wood studs in partitions or walls protected on one side with 1/2 in (13 mm) perlite-gypsum plaster<sup>2</sup> on 3/8 in (10 mm) gypsum lath.

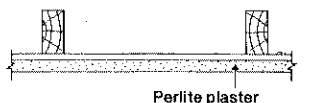

# Perlite

## FIRE RATINGS

### Floors, Roofs and Ceilings

**5 HOURS**  
U.L. DESIGN  
No. A406

Ceiling of 1 in. (26 mm) perlite-gypsum plaster<sup>2</sup> on face of 3/8 in. (10 mm) rib metal lath specially tied direct to underside of steel floor units topped with 3-1/4 in. (83 mm) concrete. Beams wrapped with 3/8 in. (10 mm) rib metal lath and plastered 1-1/2 in. (38 mm) thick over face of lath with same mix. (Beam: 4-hour).

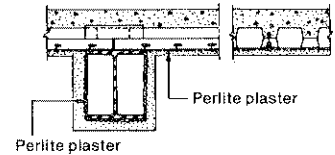

**4 HOURS**  
U.L. DESIGN  
No. A401

Floor and beam construction consisting of steel floor units mounted on steel members with 2 in. (51 mm) perlite concrete top flooring. Metal lath suspended ceiling spaced at least 3 in. (76 mm) from the steel members and covered with perlite-gypsum plaster<sup>3</sup> 1 in. (26 mm) thick over face of lath.

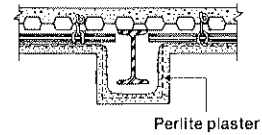

**4 HOURS**  
U.L. 2993-S

Suspended ceiling of 1 in. (26 mm) thick perlite-gypsum plaster<sup>3</sup> on face of metal lath spaced at least 3 in. (76 mm) from non-combustible structural members without a finished floor above. (NOTE: This rating applies to suspended ceilings beneath poured or precast concrete roofs, gypsum roofs, auditorium ceilings, etc.)

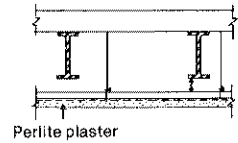

**4 HOURS**  
U.L. DESIGN  
No. A405

Floor and beam construction consisting of cellular steel floor units mounted on steel members with 2 in. (51 mm) conventional concrete top flooring. Metal lath ceiling suspended beneath beams and ducts, and covered with perlite-gypsum plaster 7/8 in. (22 mm) thick<sup>1</sup> on face of the lath. Duct openings not to exceed 70 in.<sup>2</sup> (452 cm<sup>2</sup>) per 100 ft.<sup>2</sup> (9.3 m<sup>2</sup>) of ceiling; no more than one electrical outlet per 90 ft.<sup>2</sup> (8.4 m<sup>2</sup>) of ceiling.

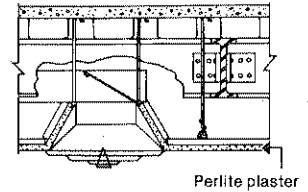

**4 HOURS**  
N.B.S.  
BMS-141

Ceiling of 1 in (26 mm) perlite-gypsum plaster<sup>1</sup> on 3/8 in (10 mm) gypsum lath attached to 3/4 in (19 mm) furring channels with interlocking wire clips. Plaster reinforced with 20 ga. wire mesh attached to furring channels. Floor slab: 2 in (51 mm) concrete on metal lath.

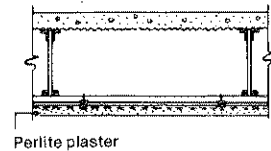

**4 HOURS**  
U.L. DESIGN  
No. D403

Ceiling of 3/8 (10 mm) perlite-gypsum plaster<sup>5</sup> measured from face of metal lath attached directly to underside of corrugated steel floor units topped with 4-1/2 in. (114 mm) of lightweight concrete; sufficient plaster pushed through lath to fill corrugations in the floor units. Beams wrapped with self-furring metal lath and plastered 1-1/2 in. (38 mm) thick over face of lath with same mix.

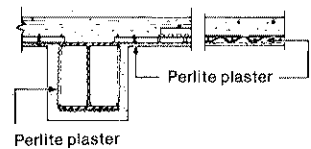

**3 HOURS**  
U.L. DESIGN  
No. P405

Roof deck of 2 in. (51 mm) minimum thickness perlite concrete on 28 gauge galvanized steel form units supported by steel joists 4 ft. (1.2 m) on center. Ceiling of 7/8 in. (22 mm) perlite-gypsum plaster<sup>3</sup> on expanded metal lath attached to 3/4 in. (19 mm) furring channels wire-tied to lower chord of joists.

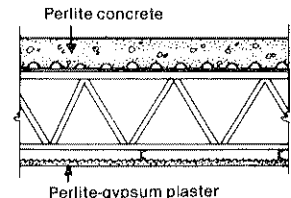

**3 HOURS**  
U.L. DESIGN  
No. P406

Roof deck of 2 1/2 in. (64 mm) perlite concrete on paper-backed welded wire mesh. Ceiling: 3/4 in. (19 mm) perlite-gypsum plaster<sup>1</sup> on face of high ribbed metal lath attached to lower chord of steel joists. (Beam 2-1/2 hours).

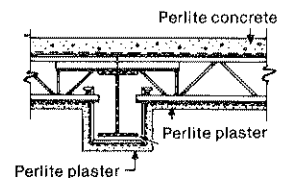

**3 HOURS**  
N.B.S.  
BMS-141

Ceiling of 5/8 in (16 mm) perlite-gypsum plaster<sup>1</sup> on 3/8 in (10 mm) gypsum lath attached to 3/4 in (19 mm) furring channels with interlocking wire clips. Plaster reinforced with 14 ga. galvanized wire attached to the clips. Floor slab: 2 in (51 mm) concrete on metal lath.

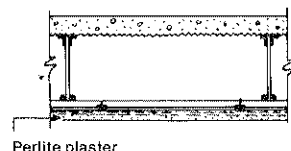

# Perlite

## FIRE RATINGS

### Floors, Roofs and Ceilings (continued)

**3 HOURS**  
U.L. DESIGN  
No. D404

Same as 4-hour U. L. Design No. D 403, but with electrical raceways and junction boxes incorporated in floor slab: 1 in. (25 mm) plaster thickness on face of lath in 3 ft.<sup>2</sup> (.28m<sup>2</sup>) area centered below junction boxes; not more than one junction box per 80 ft.<sup>2</sup> (7.4 m<sup>2</sup>) of floor.

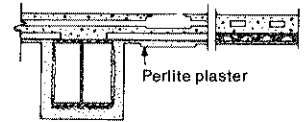

**2 HOURS**  
U.L. DESIGN  
No. P407

Roof deck of 2 in. (51 mm) minimum thickness perlite concrete on 28 gauge galvanized steel form units supported by steel joists 4 ft. (1.2 m) on center. Ceiling of 3/4 in. (19 mm) perlite-gypsum plaster<sup>9</sup> on expanded metal lath attached to 3/4 in. (19 mm) furring channels wire-tied to lower chord of joists.

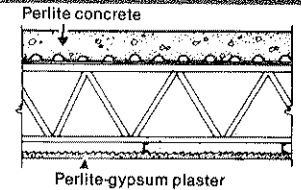

**2 HOURS**  
N.B.S.  
BMS-141

Ceiling of 1/2 in. (13 mm) perlite-gypsum plaster<sup>2</sup> on 3/8 in. (10 mm) gypsum lath secured to furring channels with wire clips; 14 ga. galvanized wire secured diagonally below the lath and fastened to the wire clips. Floor slab: 2 in. (51 mm) concrete on metal lath.

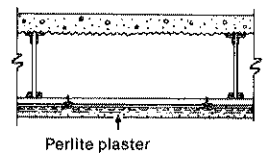

**1 3/4 HOURS**  
N.B.S. 256

Wood joists supporting wood floor protected on underside by 3/8 in. (10 mm) plain gypsum lath and 1 in. (26 mm) wire mesh nailed to joist and covered with 1/2 in. (13 mm) perlite-gypsum plaster<sup>2</sup>.

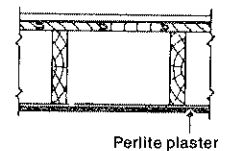

**1 1/2 HOURS**  
N.B.S. 281

Wood joists supporting wood floor protected on underside by expanded metal lath nailed to joists and covered with 5/8 in. (16 mm) perlite-gypsum plaster<sup>1</sup> measured from face of lath.

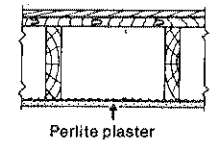

**1 1/2 HOURS**  
N.B.S.  
BMS-141

Open type steel joists with 2 in. (51 mm) reinforced concrete slab protected on the underside by 3/8 in. (10 mm) gypsum lath attached to 3/4 in. (19 mm) furring channels with interlocking wire clips, plastered with 1 in. (26 mm) perlite-gypsum plaster<sup>1</sup>

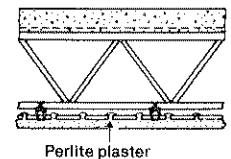

**1 HOUR**  
U.L. DESIGN  
No. P903

Galvanized corrugated steel deck units topped with 3-1/2 in. (89 mm)\*\* perlite concrete reinforced with 48-1214 wire mesh; no ceiling protection. Beams wrapped with metal lath and plastered with 7/8 in. (22 mm) perlite-gypsum plaster<sup>1</sup>.

\*\* (measured from bottom of corrugation; average perlite concrete thickness 2-5/8 in. (67 mm).

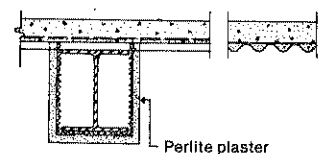

**1 HOUR**  
N.B.S.  
BMS-141

Steel joists 24 in. (610 mm) on center supporting 2 in. (51 mm) concrete floor protected on underside by 3/8 in. (10 mm) gypsum lath and 5/8 in. (16 mm) thick perlite-gypsum plaster<sup>2</sup> supported by 3/4 in. (19 mm) furring channels and special metal clips.

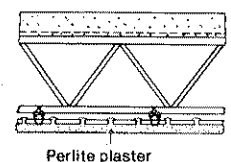

**1 HOUR**  
N.B.S. 258

Wood joists supporting wood floors protected on underside by 3/8 in. (10 mm) gypsum lath nailed on and covered with 1/2 in. (13 mm) perlite-gypsum plaster<sup>2</sup>

